

# DIN 卡套式管接头

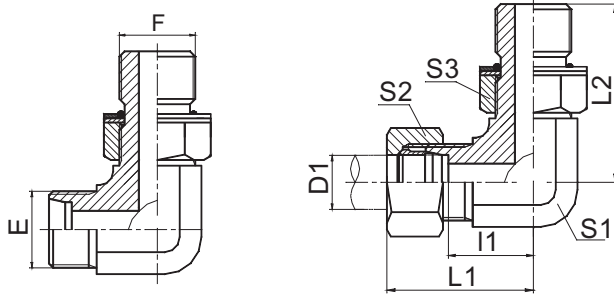

90° 弯英管螺纹可调向O形圈密封柱端  
 90° ELBOW BSP THREAD ADJUSTABLE  
 STUD ENDS WITH O-RING SEALING

**1CG9-OG**  
**1DG9-OG**

**1CG9-OG/RN**  
**1DG9-OG/RN**

代号 PART NO.	螺纹 THREAD		管子外径 TUBE O.D. D1	尺寸 DIMENSIONS						压力等级 MPa	
	E	F		l1	L1	L2	S1	S2	S3		
1CG9-12-02OG	M12X1.5	G1/8"X28	6	13	28	26.2	11	14	14	31.5 轻系列 L	
1CG9-14-04OG	M14X1.5	G1/4"X19	8	15.5	30.5	31.3	14	17	19		
1CG9-16-04OG	M16X1.5	G1/4"X19	10	17.5	32.5	32.5	16	19	19		
1CG9-16-06OG	M16X1.5	G3/8"X19	10	17.5	32.5	35.8	16	19	22		
1CG9-18-06OG	M18X1.5	G3/8"X19	12	19	34	36.8	19	22	22		
1CG9-22-08OG	M22X1.5	G1/2"X14	15	22	37	43.2	22	27	27		
1CG9-26-08OG	M26X1.5	G1/2"X14	18	25.5	42	46	27	32	27		
1CG9-26-12OG	M26X1.5	G3/4"X14	18	25.5	42	49.3	27	32	32		
1CG9-30-12OG	M30X2	G3/4"X14	22	29.3	45.8	52	30	36	32		16 轻系列 L
1CG9-30-16OG	M30X2	G1"X11	22	31.5	48	53	33	36	41		
1CG9-36-16OG	M36X2	G1"X11	28	33	49.8	56	36	41	41		
1CG9-36-20OG	M36X2	G1.1/4"X11	28	36	52.8	59	41	41	50		
1CG9-45-20OG	M45X2	G1.1/4"X11	35	39.2	60.7	63	48	50	50		
1CG9-52-24OG	M52X2	G1.1/2"X11	42	44.8	67.8	68.5	55	60	55	63 重系列 S	
1DG9-14-04OG	M14X1.5	G1/4"X19	6	17.5	32.5	31.3	14	17	19		
1DG9-16-04OG	M16X1.5	G1/4"X19	8	18.7	33.7	32.5	16	19	19		
1DG9-16-06OG	M16X1.5	G3/8"X19	8	18.7	33.7	35.8	16	19	22		
1DG9-18-06OG	M18X1.5	G3/8"X19	10	19.5	36	36.8	19	22	22		
1DG9-20-06OG	M20X1.5	G3/8"X19	12	19.5	36	36.8	19	24	22		
1DG9-22-08OG	M22X1.5	G1/2"X14	14	23	41	43.2	22	27	27		
1DG9-24-08OG	M24X1.5	G1/2"X14	16	24	42.5	43	24	30	27		40 重系列 S
1DG9-30-12OG	M30X2	G3/4"X14	20	28	49.5	52	30	36	32		
1DG9-36-16OG	M36X2	G1"X11	25	32.8	56.8	56	36	46	41		
1DG9-42-20OG	M42X2	G1.1/4"X11	30	36.2	62.7	58	41	50	50		
1DG9-52-24OG	M52X2	G1.1/2"X11	38	45.8	76.8	68.5	55	60	55	31.5重系列S	

注：如需带卡套及卡套螺母整套订货，则请在代号后加“RN”，如1CG9-30-12OG/RN。

Note: In case if you are interested to order the adapter in complete set with cutting ring and nut ,it is necessary to insert suffix "RN" after our part no., for example 1CG9-30-12OG/RN.